

A24 LONDON ROAD/EPSOM ROAD/ CENTRAL ROAD CYCLING IMPROVEMENTS

KEY

- PROPOSED SHARED USE CYCLIST AND PEDESTRIAN FOOTWAY
 - EXISTING FOOTWAY
- EXISTING GRASS VERGE
 - EXISTING PARKING / LOADING BAY / BUS STOP
- MANDATORY 1.5M MANDATORY CYCLE LANE
 - PROPOSED NEW TREE

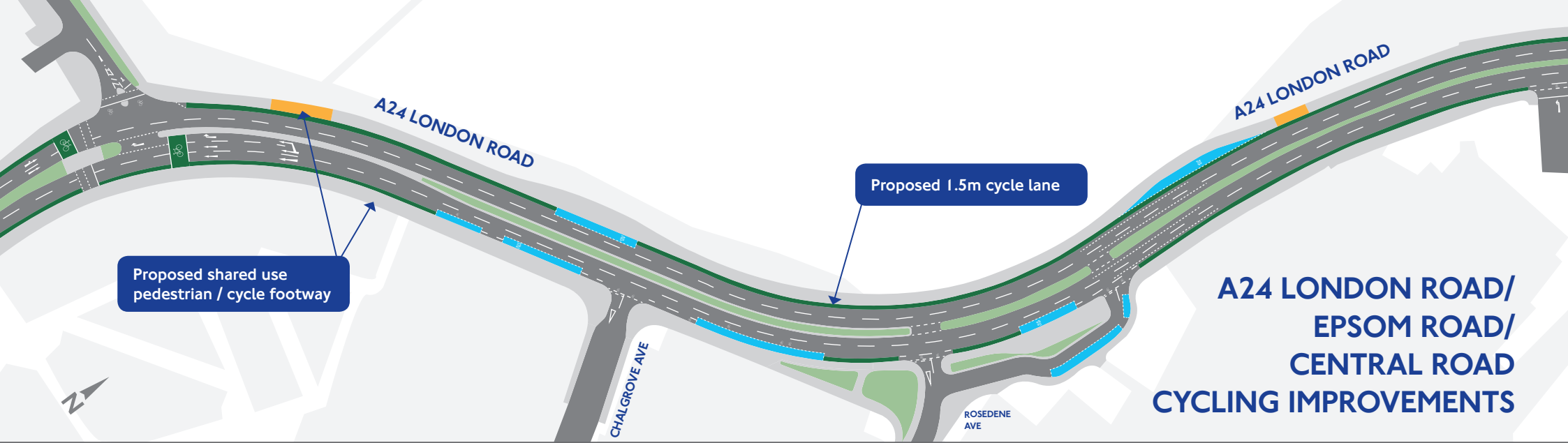

**A24 LONDON ROAD/
EPSOM ROAD/
CENTRAL ROAD
CYCLING IMPROVEMENTS**



KEY

- PROPOSED SHARED USE CYCLIST AND PEDESTRIAN FOOTWAY
 - EXISTING FOOTWAY
- EXISTING GRASS VERGE
 - EXISTING PARKING / LOADING BAY / BUS STOP
- MANDATORY 1.5M MANDATORY CYCLE LANE