

# Waterloo to Greenwich Quietway

## Tower Bridge Road - Rothsay Street / Webb Street

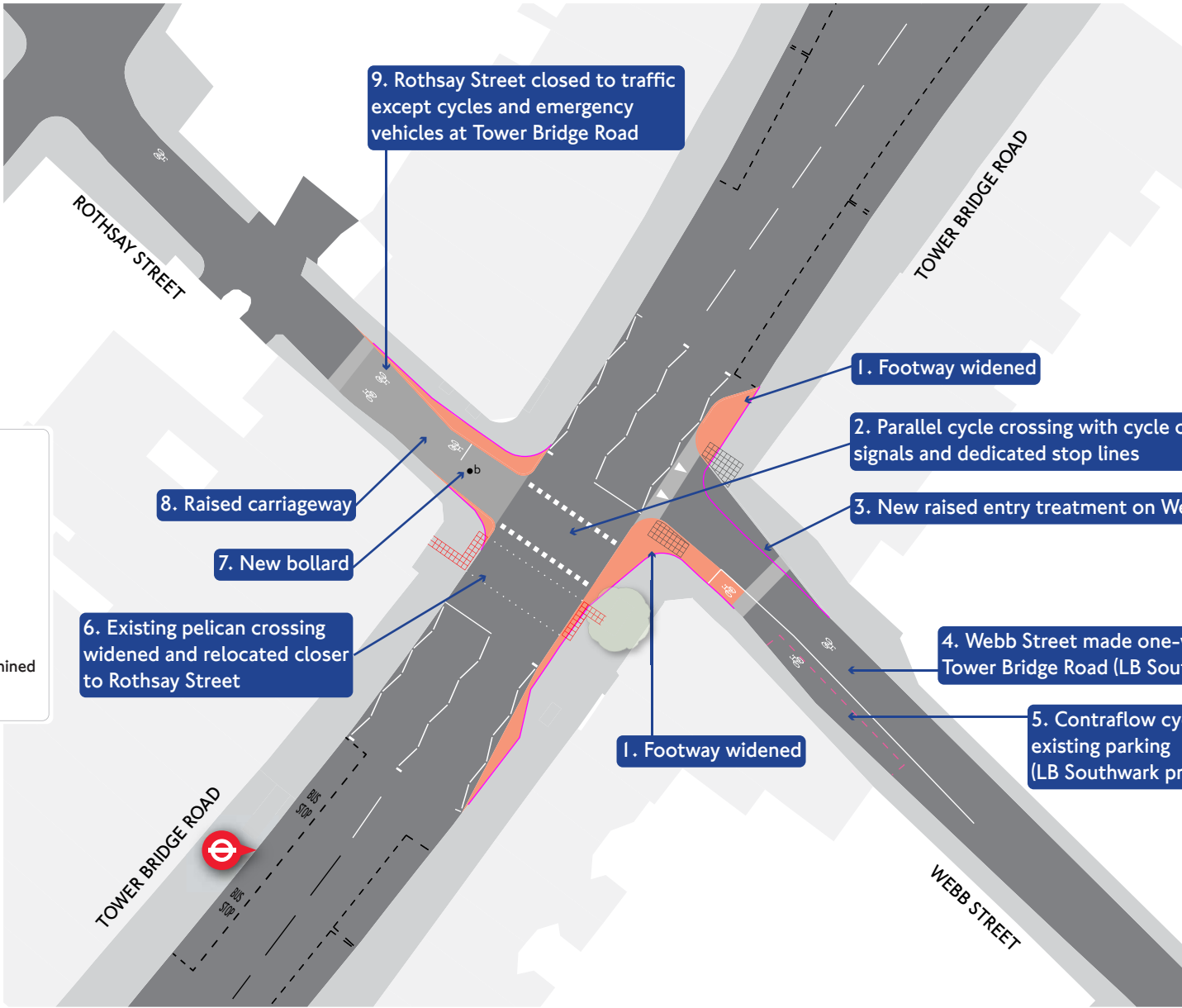

**Key:**

- Existing road markings
- Existing marking removed
- Existing kerbline removed
- New footway or traffic island
- New road markings
- New tactile paving
- New bollard, type to be determined
- Bus stop

9. Rothsay Street closed to traffic except cycles and emergency vehicles at Tower Bridge Road

1. Footway widened

2. Parallel cycle crossing with cycle only signals and dedicated stop lines

3. New raised entry treatment on Webb Street

8. Raised carriageway

7. New bollard

6. Existing pelican crossing widened and relocated closer to Rothsay Street

4. Webb Street made one-way from Tower Bridge Road (LB Southwark proposals)

5. Contraflow cycle lane replaces existing parking (LB Southwark proposals)

1. Footway widened