

Changes on Kennington Park Road due to upgrade of CS7 (Map A)



Existing bus stop C retained

Existing bus stop N retained

HARLEYFORD STREET



SCHEME EXTENTS

Bus lane extended to Advanced Stop Line

Existing bus stop Q retained

Bus lane made 24hr

Bus lane made 24hr

Existing bus stand retained

HANOVER GARDENS

Loading and disabled parking bays retained and hours changed to Mon to Sun 10am - 2pm

FOR CONTINUATION SEE MAP B

Existing bus stop R retained

Bus lane made 24hr

PRIMA ROAD

ELIAS PLACE

Monument

BRIXTON ROAD

CAMBERWELL NEW ROAD

St. Mark's Church

War Memorial

Indicative designs that may be subject to change

Email feedback to: [streetspacelondon@tfl.gov.uk](mailto:streetspacelondon@tfl.gov.uk)

© Crown copyright and database rights 2020  
Ordnance Survey 100035971

**Changes on Clapham Road due to upgrade of CS7 (Map B)**

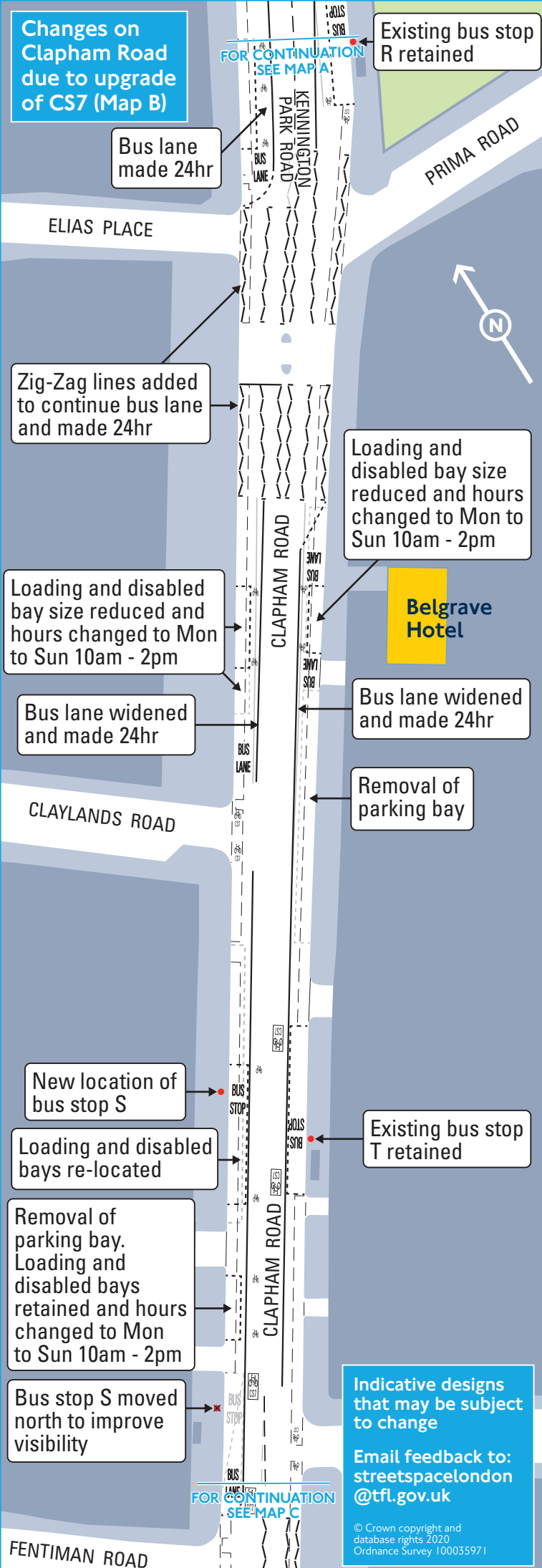

**Changes on Clapham Road due to upgrade of CS7 (Map C)**

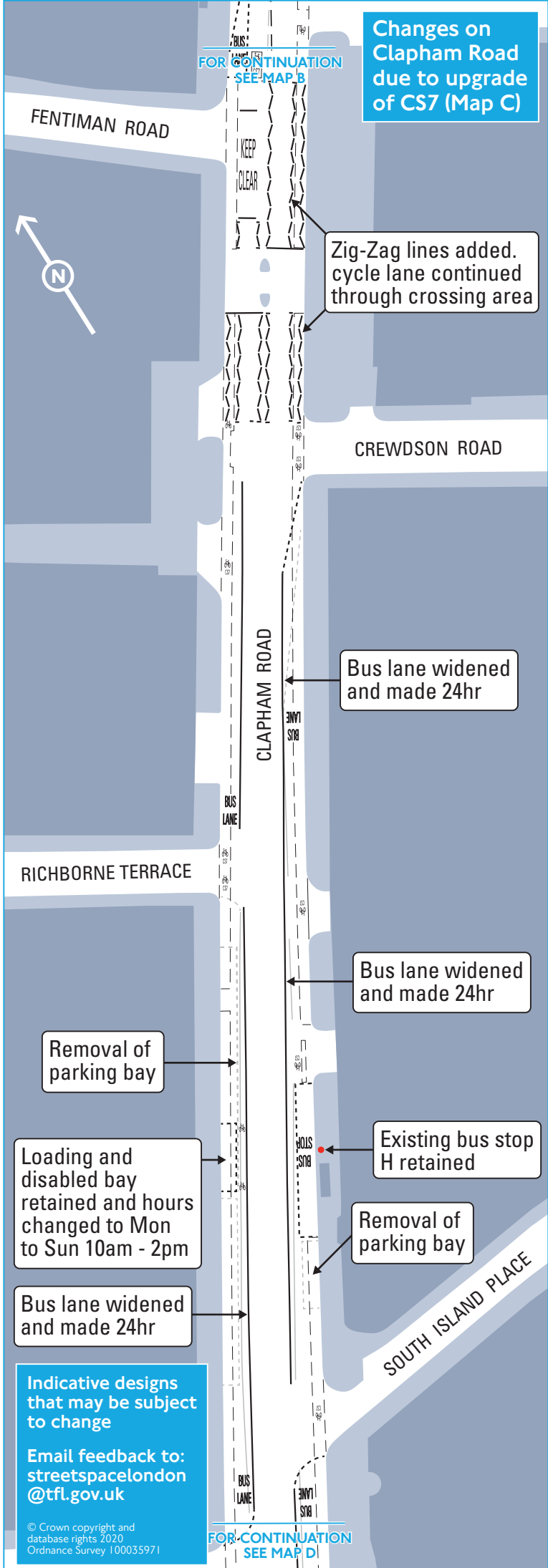

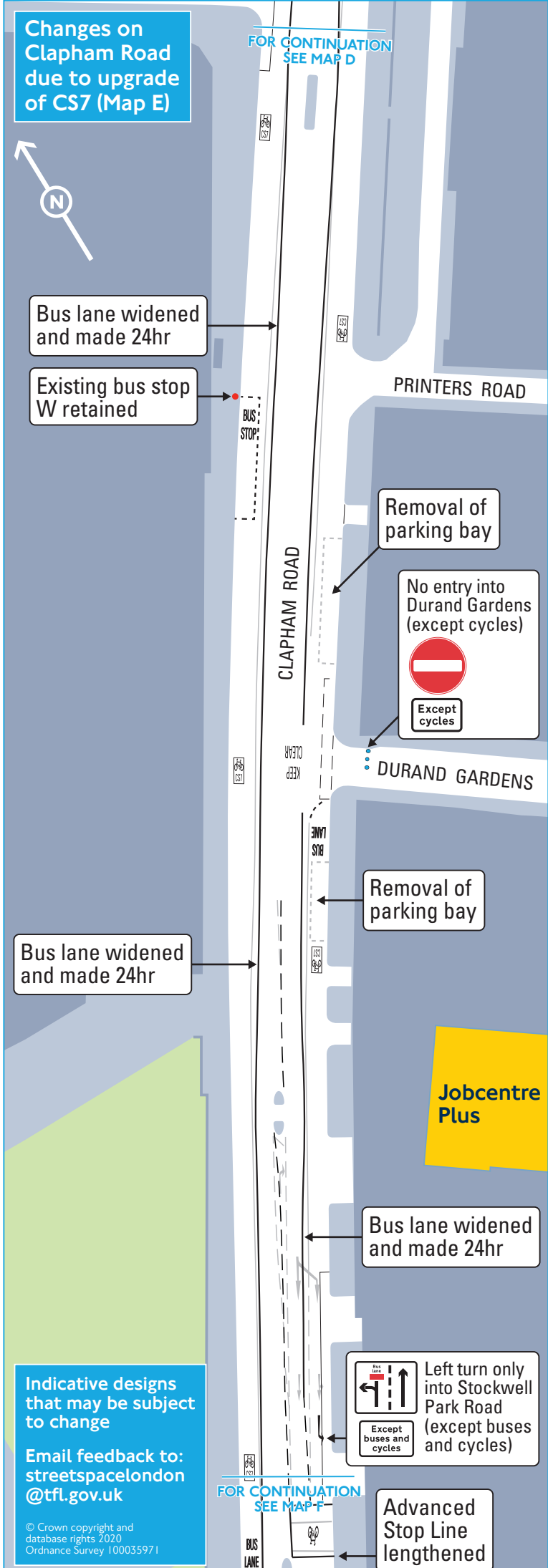
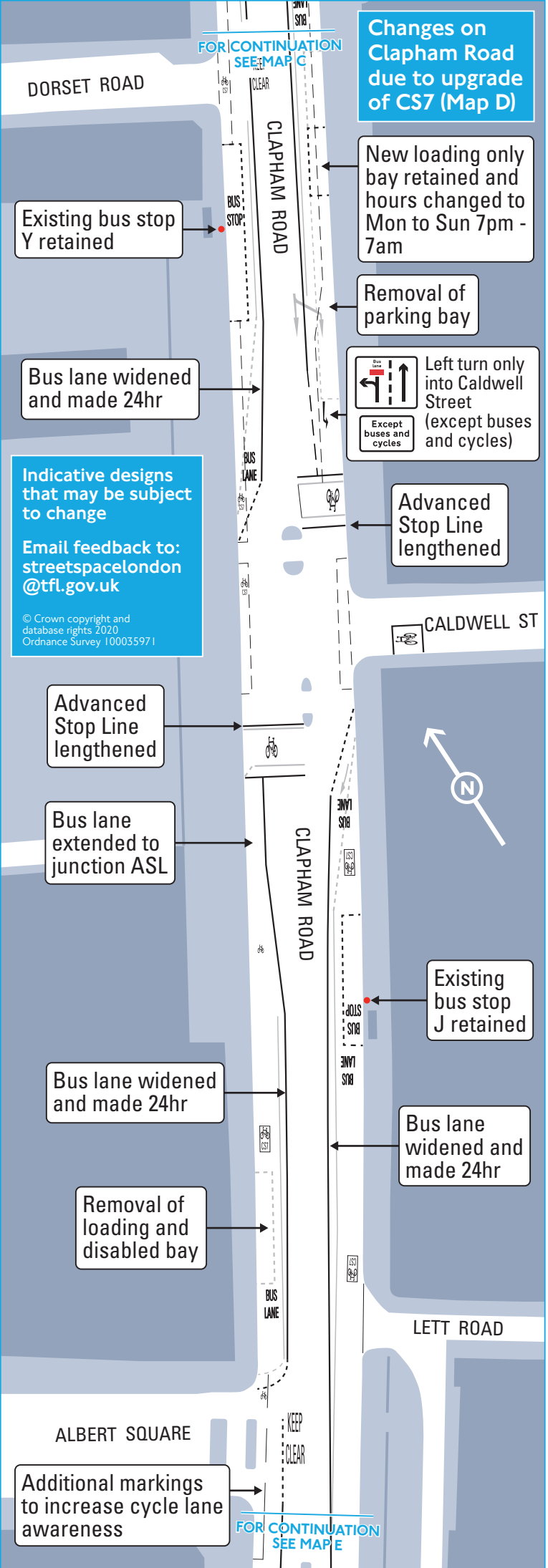

**Changes on Clapham Road due to upgrade of CS7 (Map F)**

Bus lane extended to junction

Advanced Stop Line lengthened

Loading and disabled bay re-located

Loading and disabled bay size reduced and hours changed to Mon to Sun 10am - 2pm

Existing bus stop D retained

Bus lane slightly widened around bus stop to aid cycle passing

Bus lane made 24hr

Indicative designs that may be subject to change  
 Email feedback to: [streetspacelondon@tfl.gov.uk](mailto:streetspacelondon@tfl.gov.uk)  
© Crown copyright and database rights 2020  
 Ordnance Survey 100035971

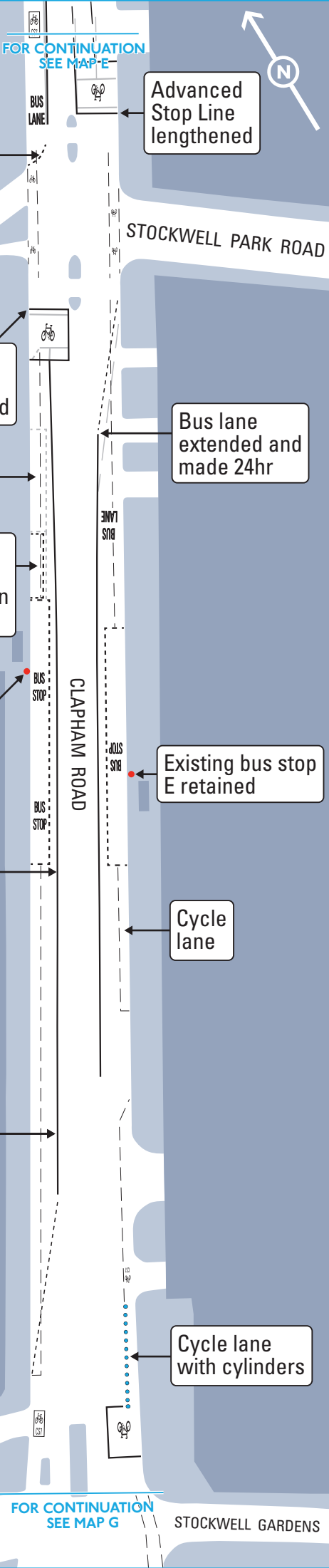

FOR CONTINUATION SEE MAP G

**Changes on Clapham Road due to upgrade of CS7 (Map G)**

SOUTH LAMBETH ROAD

Stockwell Memorial Garden

BINFIELD ROAD

Stockwell

Existing bus stop F retained

Existing bus stop G retained

Indicative designs that may be subject to change  
 Email feedback to: [streetspacelondon@tfl.gov.uk](mailto:streetspacelondon@tfl.gov.uk)  
© Crown copyright and database rights 2020  
 Ordnance Survey 100035971

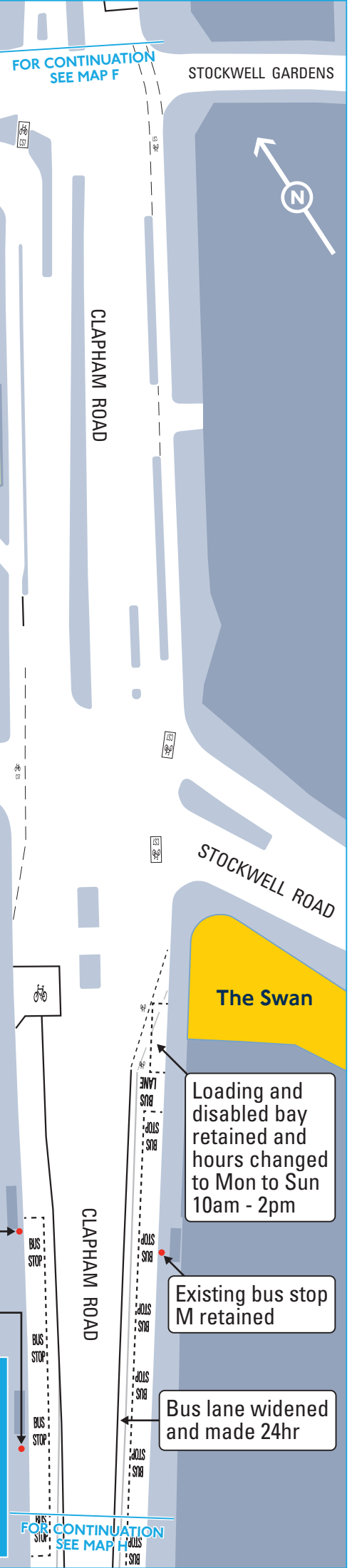

FOR CONTINUATION SEE MAP H

**Changes on Clapham Road due to upgrade of CS7 (Map H)**

FOR CONTINUATION SEE MAP G

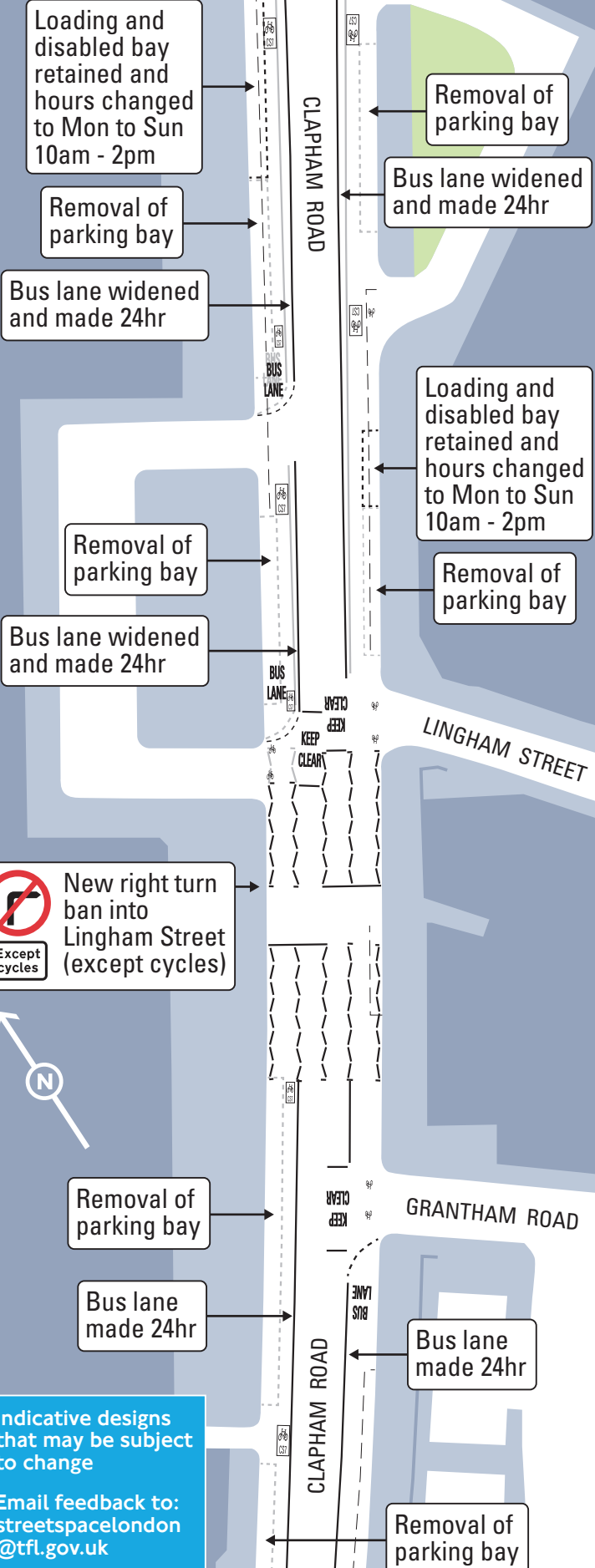

Indicative designs that may be subject to change  
 Email feedback to: [streetspacelondon@tfl.gov.uk](mailto:streetspacelondon@tfl.gov.uk)

© Crown copyright and database rights 2020  
 Ordnance Survey 100035971

FOR CONTINUATION SEE MAP I

**Disabled parking bay**

FOR CONTINUATION SEE MAP H

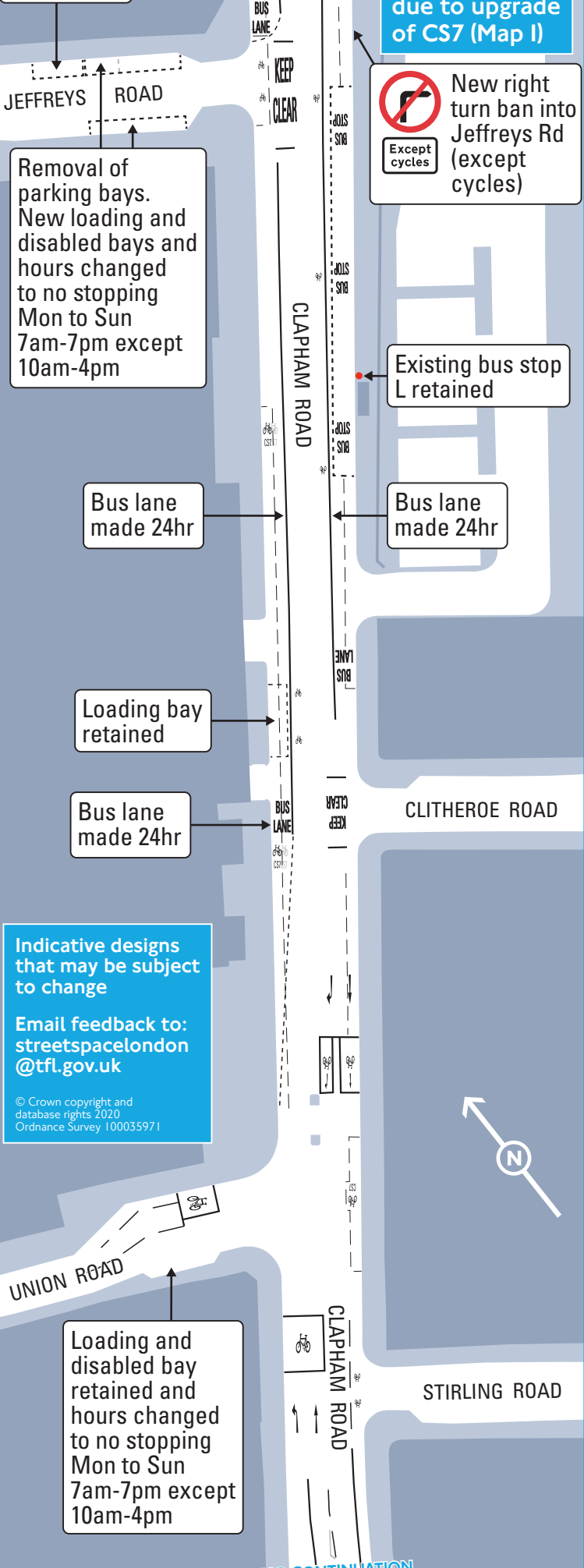

**Changes on Clapham Road due to upgrade of CS7 (Map I)**

Indicative designs that may be subject to change  
 Email feedback to: [streetspacelondon@tfl.gov.uk](mailto:streetspacelondon@tfl.gov.uk)  
 © Crown copyright and database rights 2020  
 Ordnance Survey 100035971

FOR CONTINUATION SEE MAP J



**Changes on Clapham Road due to upgrade of CS7 (Map J)**

Loading and disabled bay shortened and hours changed to Mon to Sun 10am - 2pm

Existing bus stop J retained

Bus lane widened

Realigned N/B right turn lane to allow wider bus lanes and S/B cycle lane

Bus lane widened

Removal of parking bay

Bus lane made 24hr

**St. John the Evangelist**

Bus lane made 24hr

Removal of parking bay

Indicative designs that may be subject to change

Email feedback to: [streetspacelondon@tfl.gov.uk](mailto:streetspacelondon@tfl.gov.uk)

© Crown copyright and database rights 2020  
Ordnance Survey 100035971

**Changes on Clapham Road due to upgrade of CS7 (Map K)**

Bus lane widened and made 24hr

Bus lane made 24hr

Indicative designs that may be subject to change

Email feedback to: [streetspacelondon@tfl.gov.uk](mailto:streetspacelondon@tfl.gov.uk)

© Crown copyright and database rights 2020  
Ordnance Survey 100035971

Existing bus stop C retained

Bus lane widened and made 24hr

Advanced Stop Line lengthened to 7.5m

New left turn ban into Clapham High Street

Advanced Stop Line lengthened to 7.5m

Loading and disabled bay shortened and hours changed to Mon to Sun 7pm - 7am

Removal of loading and disabled bay

Existing loading only bay retained

Left turn only into Landor Road (except buses and cycles)

**Clapham North**

Existing bus stop F retained

Bus lane made 24hr

Existing bus stop G retained

FOR CONTINUATION SEE MAP K

FOR CONTINUATION SEE MAP L

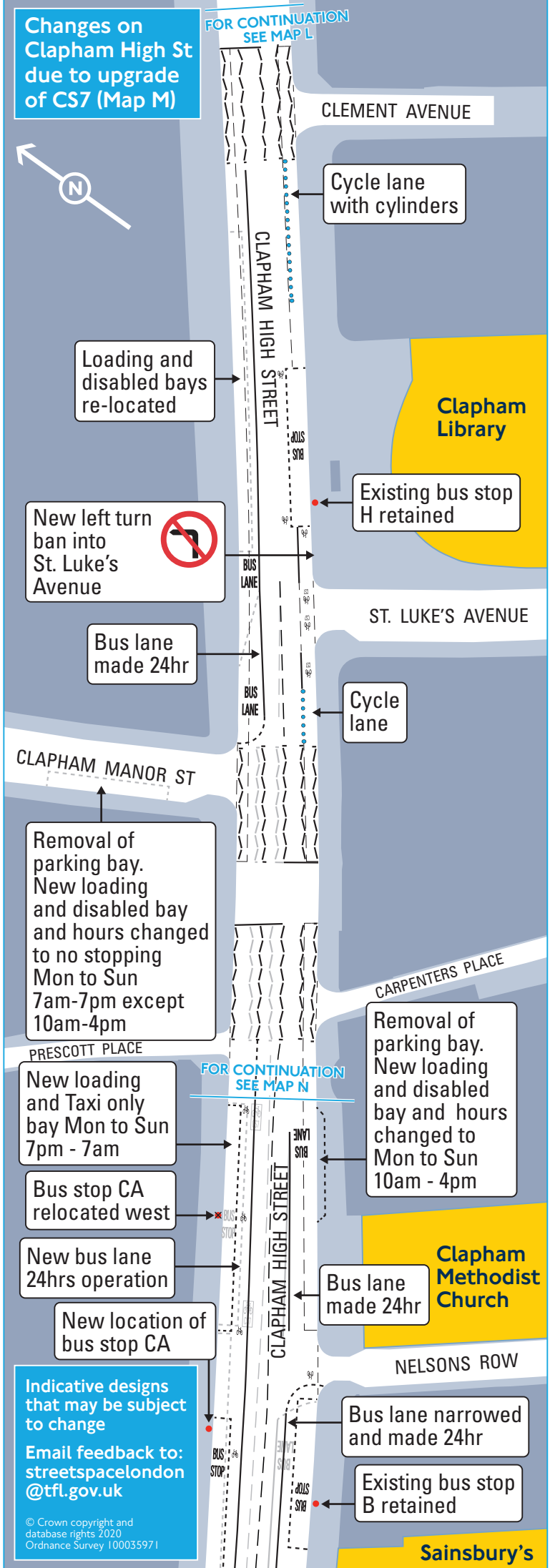
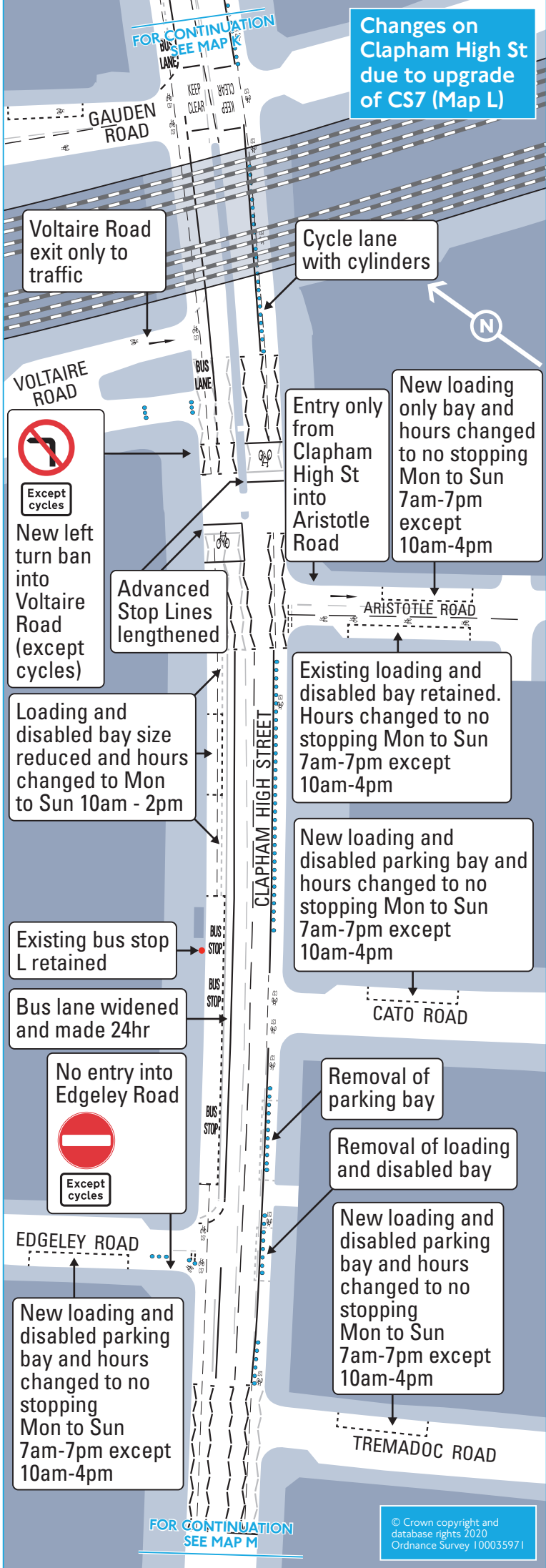

**Changes on Clapham High Street due to upgrade of CS7 (Map N)**

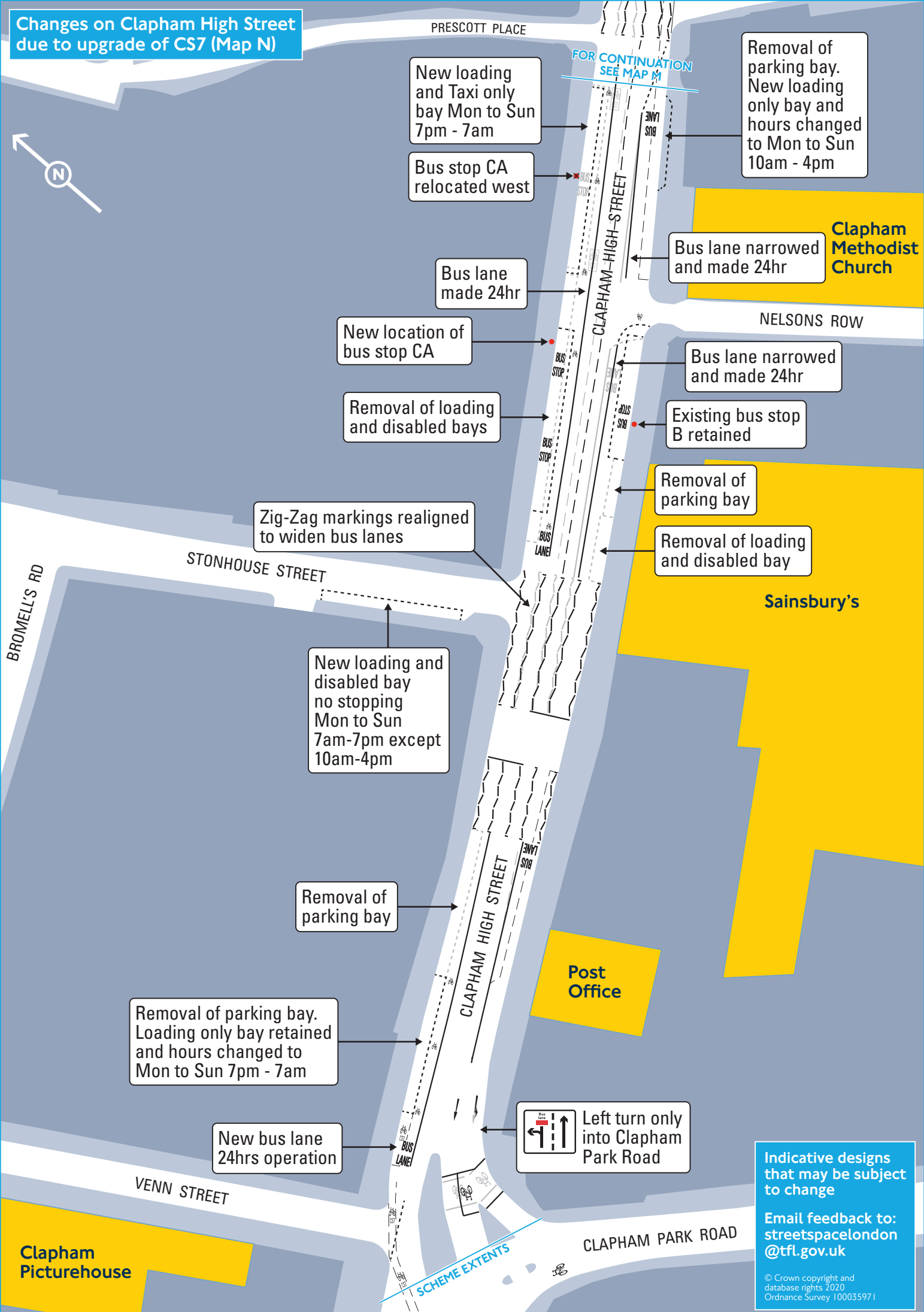
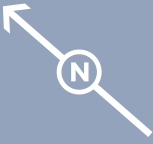

New loading and Taxi only bay Mon to Sun 7pm - 7am

Bus stop CA relocated west

Removal of parking bay. New loading only bay and hours changed to Mon to Sun 10am - 4pm

Bus lane narrowed and made 24hr

Bus lane made 24hr

New location of bus stop CA

Bus lane narrowed and made 24hr

Removal of loading and disabled bays

Existing bus stop B retained

Zig-Zag markings realigned to widen bus lanes

Removal of parking bay

Removal of loading and disabled bay

STONHOUSE STREET

New loading and disabled bay no stopping Mon to Sun 7am-7pm except 10am-4pm

Sainsbury's

Removal of parking bay

Post Office

Removal of parking bay. Loading only bay retained and hours changed to Mon to Sun 7pm - 7am

New bus lane 24hrs operation

Left turn only into Clapham Park Road

VENN STREET

Clapham Picturehouse

CLAPHAM PARK ROAD

SCHEME EXTENTS

Indicative designs that may be subject to change

Email feedback to: [streetspacelondon@tfl.gov.uk](mailto:streetspacelondon@tfl.gov.uk)

© Crown copyright and database rights 2020 Ordnance Survey 100035971