

Bus lane extension at Loampit Vale (A20)

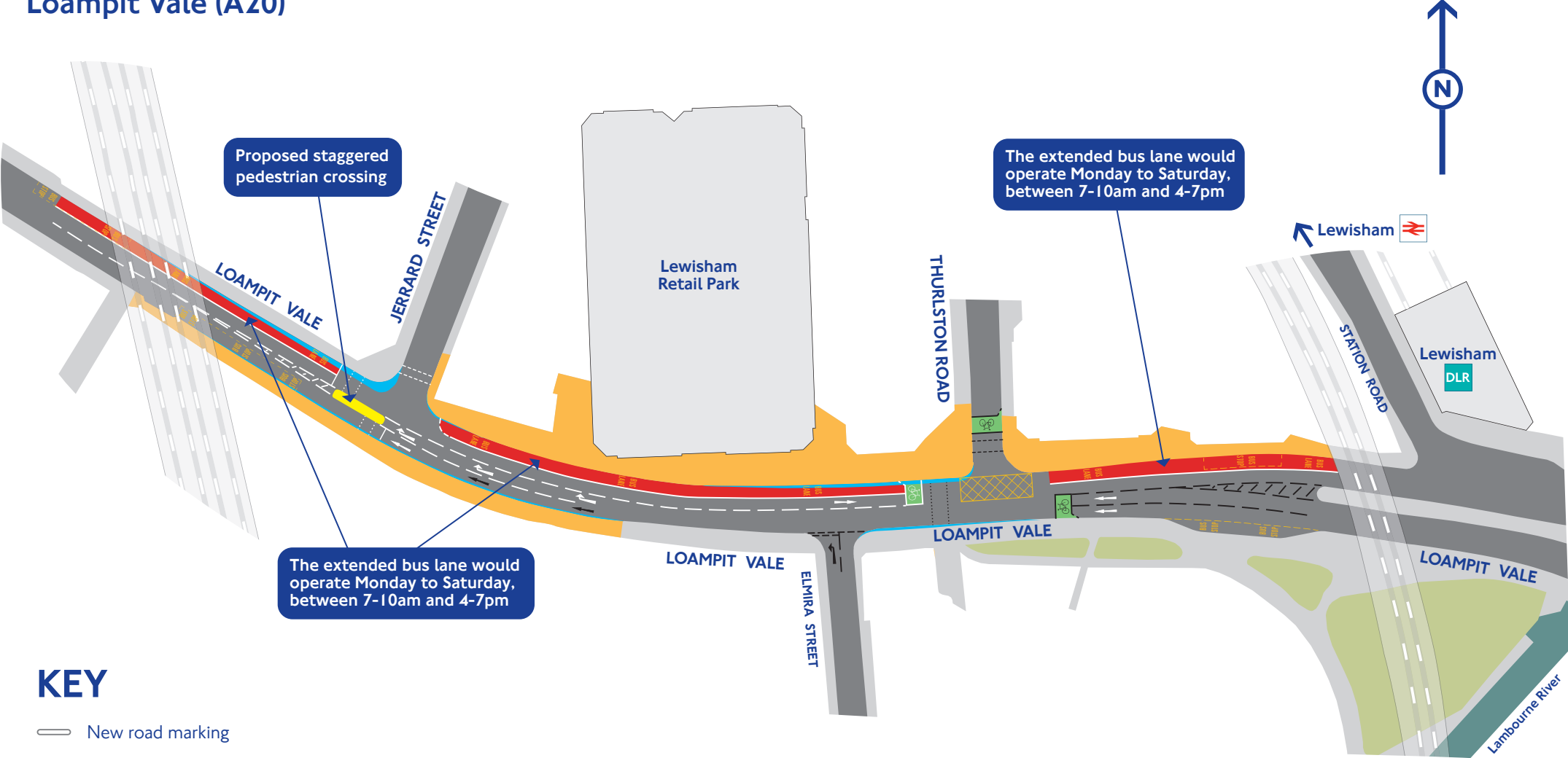

KEY

-  New road marking
-  Existing road marking
-  Proposed bus lane extension
Bus, cycle, taxi and motorcycles.
Operating Monday to Saturday, between 7-10am and 4-7pm
-  Resurfaced footway
-  Advanced cycle stop line
-  Widened carriageway
-  Proposed staggered pedestrian crossing